

*Live!  
At the Shell*

## **Recreation Park Bandshell, Long Beach CA**

701-939 Federation Dr, Long Beach, CA 90804

## **Technical Information for Bands & Vendors**

Produced by *Live at The Shell* a 501c3 nonprofit

[info@liveattheshell.org](mailto:info@liveattheshell.org)

[www.liveattheshell.org](http://www.liveattheshell.org)

# About the Bandshell

- *The Shell* at Rec Park is Long Beach's Premier Outdoor Amphitheater.
- *The Shell* has many unique features that make it a great venue for outdoor music and theatre including:
  - Large 30x60 ft raised stage plus backstage and wing stage areas.
  - Seating for over 600 plus additional grass areas for open picnic space.
  - Two story indoor area with space for a green room, restrooms, bridal suite, music rehearsal space, or other uses as needed.
  - Directly next to the new children's playground and public restrooms.
  - Located in Recreation Park, a large recreational area with good parking, across from Wilson HS, next to Blair Field.
  - Near Long Beach residential areas, but far enough away to mitigate noise.

The Spanish Baroque Revival Bandshell was built in 1929 and is a Registered Historic Landmark



Stage Side Building



Street Side Building Entrance

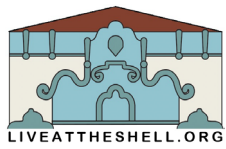

# About *Live at The Shell*

- *Live at The Shell* is a 501.c.3 non-profit.
- *Live at The Shell* volunteers are local musicians, sound engineers and arts patrons that want to help bring back live music to *The Shell*.
- At *Live at The Shell* we have the following goals
  - Bring back the regular use of the Historic Landmark Bandshell.
  - Focus on local Long Beach talent including our community's youth.
  - Raise funds over time through government, business and private donations for full renovation of the Bandshell.
  - Create a lasting foundation that will promote the use and maintenance of the Bandshell for years to come.

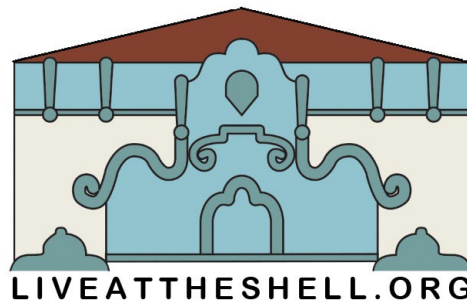

# Location and Layout

Location: 701-939 Federation Dr, Long Beach, CA 90814 at the corner of E 7<sup>th</sup> St and Park Ave



# Location and Layout





# All Parking is FREE

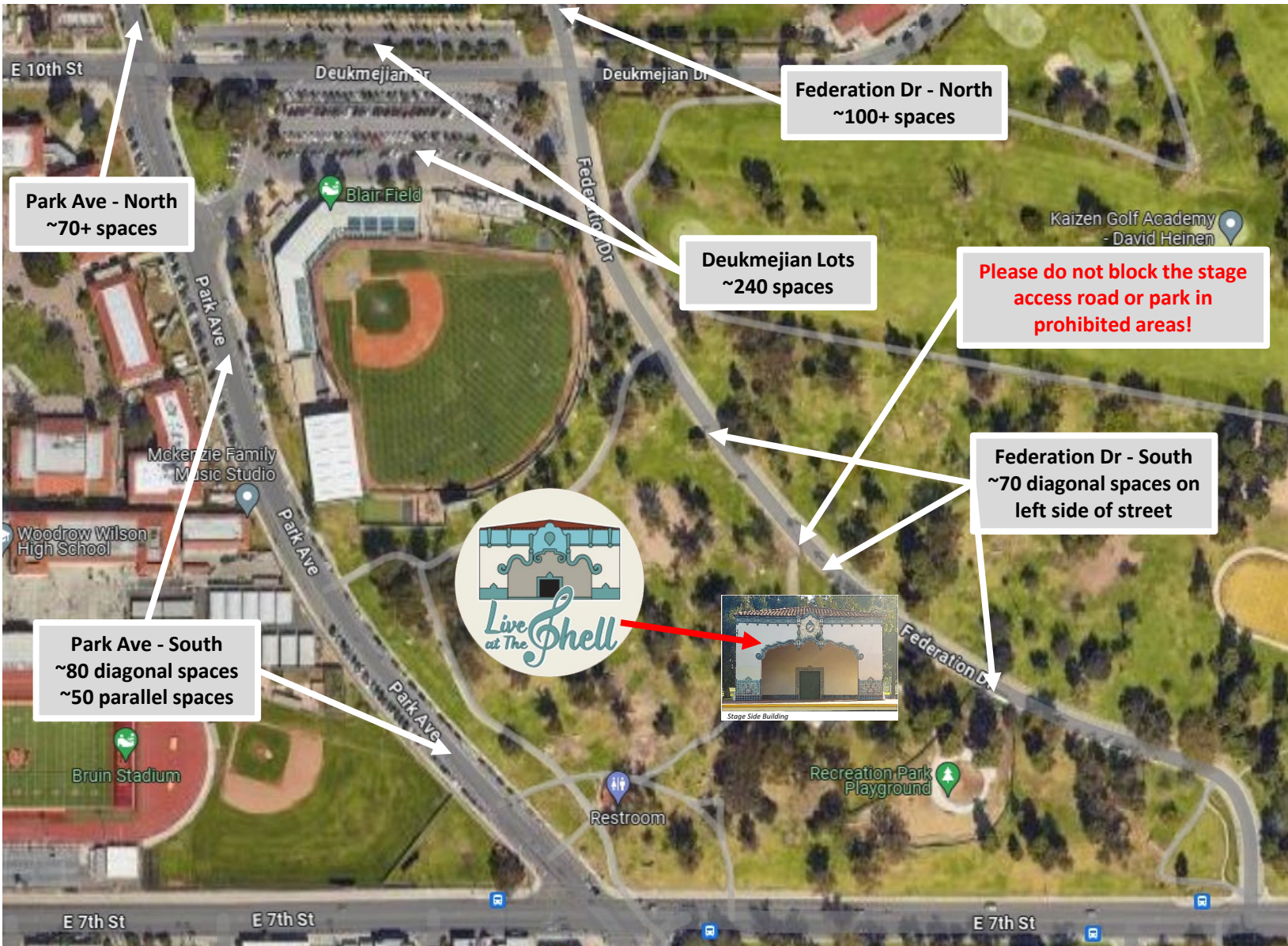

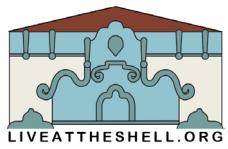

# Stage Dimensions

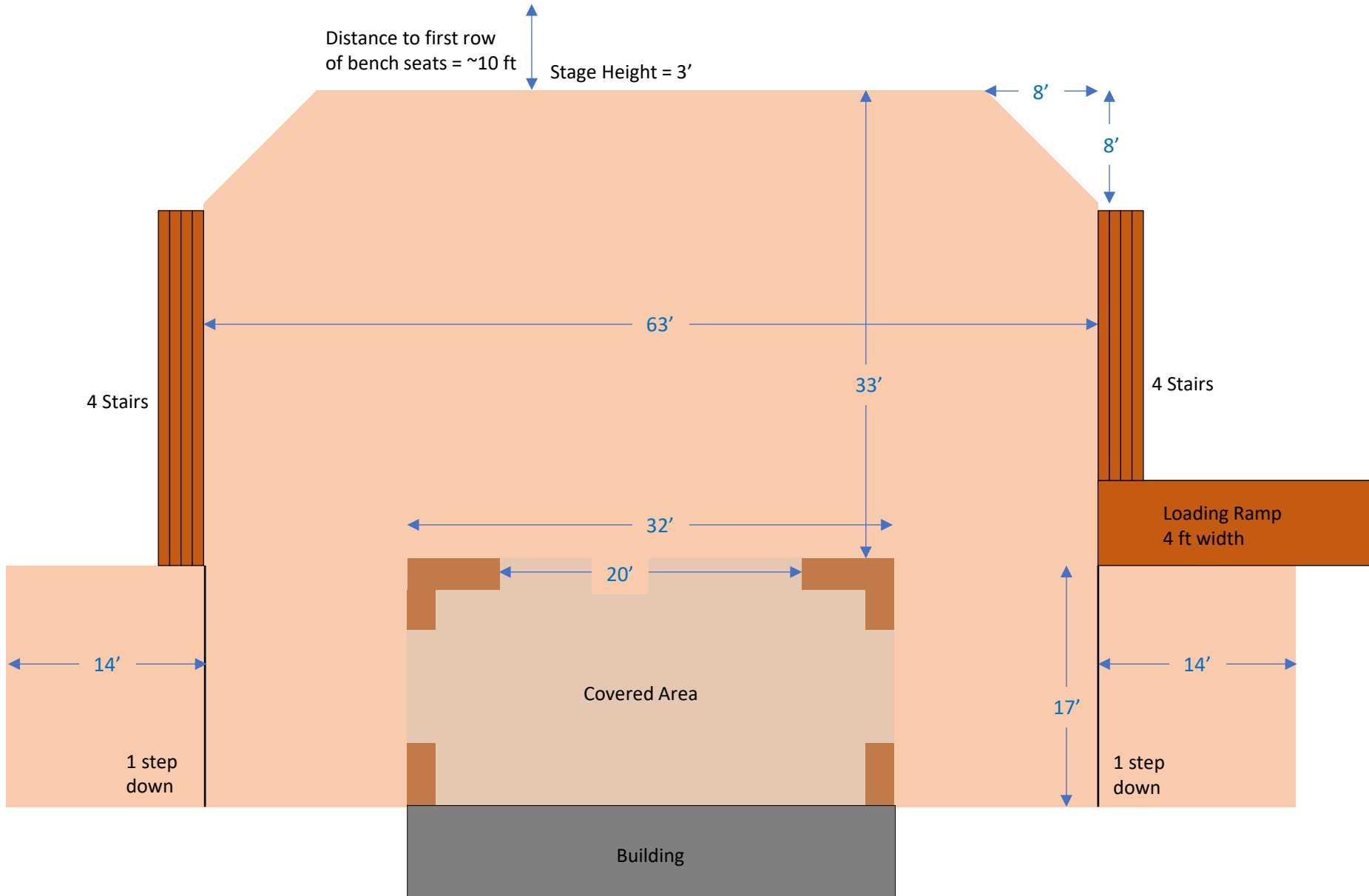

# Interior Building – First Floor

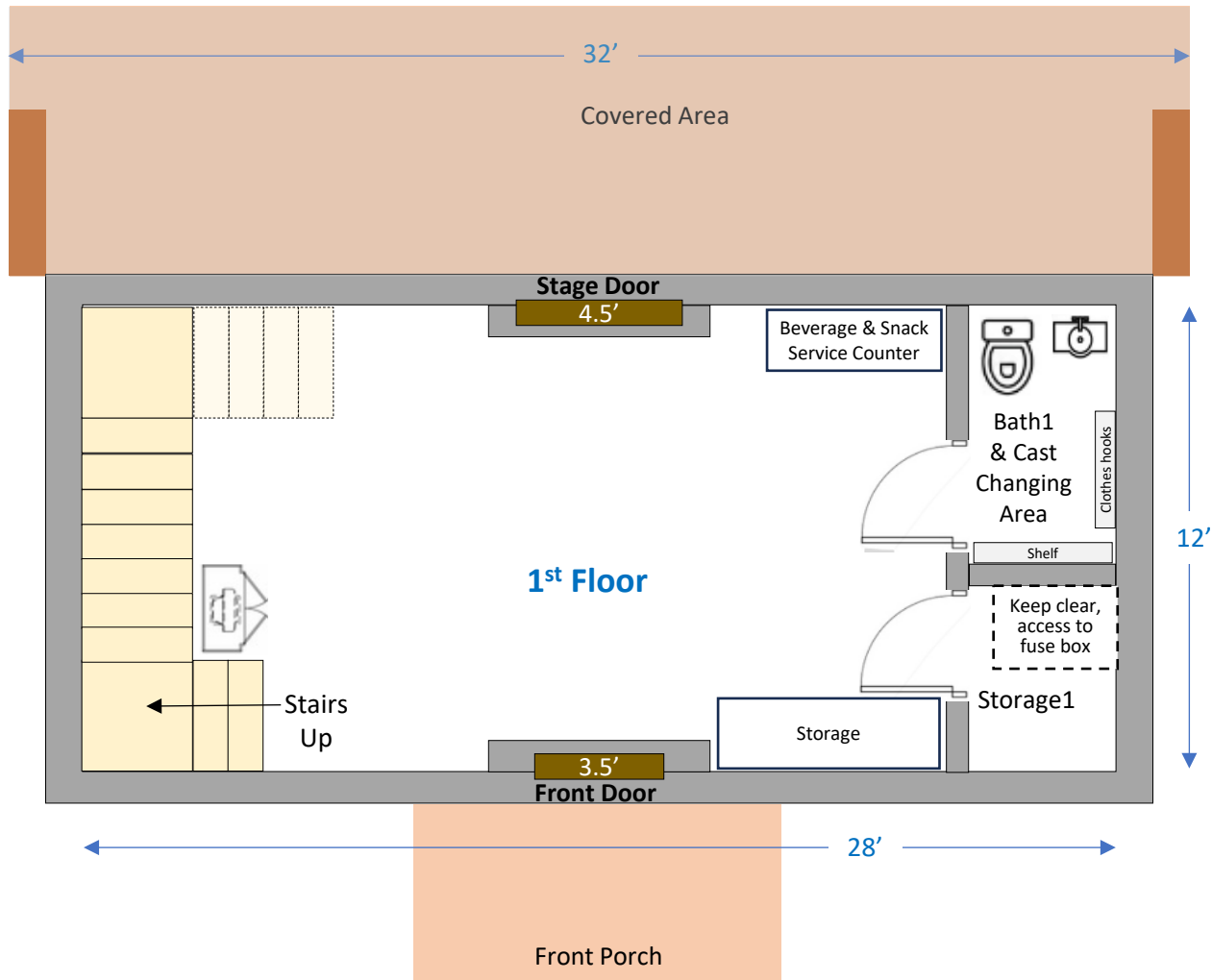

# Interior Building – Second Floor

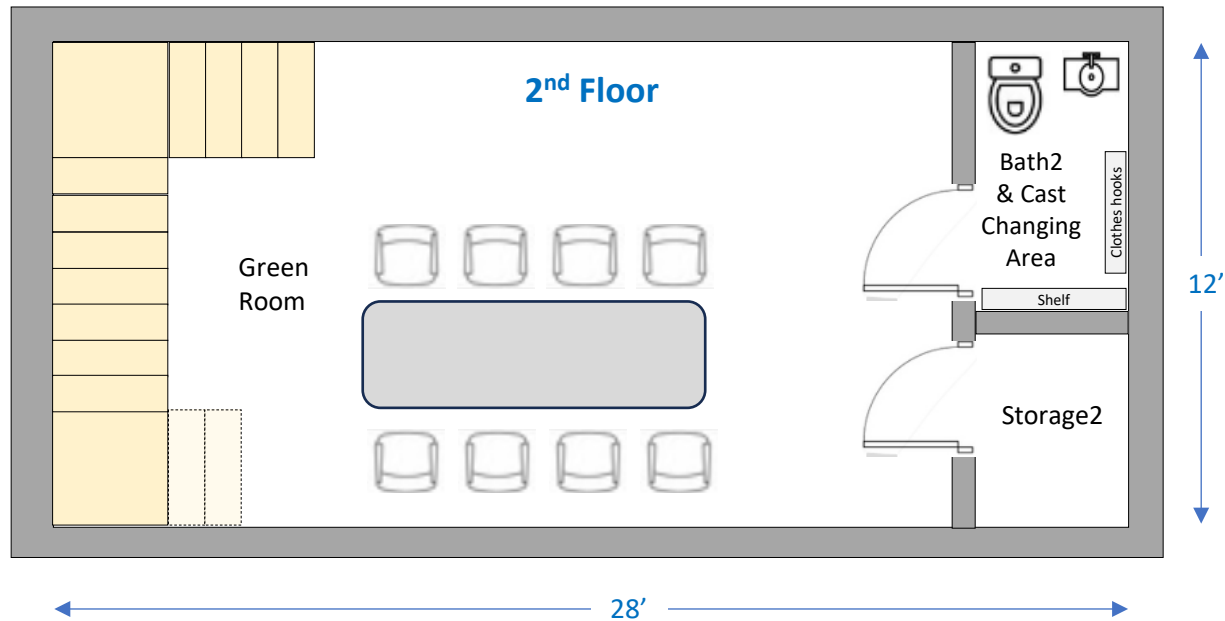

# Typical Stage Setup

## Example Setup Rec Park Bandshell

### Channels

1. VOX 1 (W1)
2. VOX 2 (W2)
3. VOX 3 (W3)
4. VOX 4 (W4)
5. VOX 5 (W5)
- 8: VOX MC (W8)
- 9: Lead GTR (W6)
10. Bass GTR - DI
11. Sax (Band wireless)
12. Trumpet (Band wireless)
- 13-14. Keys - DI
- 15-16. House
- 17-19. Drums

### Output Channels

- 1-6. Monitor Wedges
- 15-16. Mains

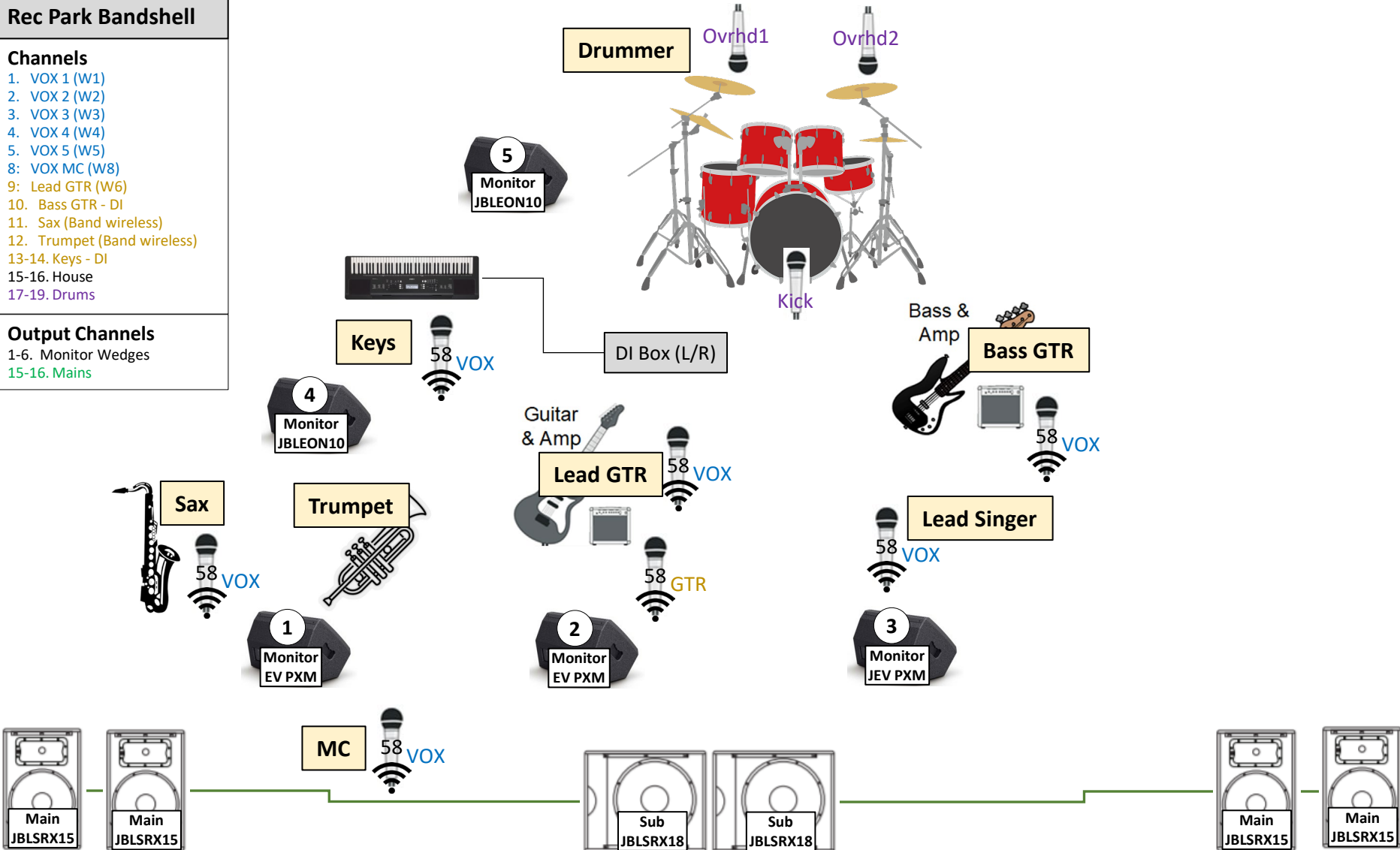

# Typical Sound Engineer Setup

UP  
STAGE

P16 Hub

Behringer SD16  
**16 Inputs**  
**8 Outputs**



Up Stage Inst. &  
Stage Monitors

DOWN  
STAGE

Shure ULXD Wireless  
Mics, 8 Chan

Midas DL32  
**32 Inputs**  
**16 Outputs**



Mains, Subs, &  
Down Stage  
Inst. & Stage  
Monitors

~50 feet to FOH

FRONT of  
HOUSE

Behringer  
Wing  
Compact



"Park: PAs

- PA
  - 4x JBL SRX 15" tops & 2x 18" subwoofers.
  - 4x JBL EON712 12" for time delayed coverage beyond the benches to the grass areas.
- Mixer
  - Behringer Wing Compact 40 Chan mixer Plus 16 & 32 Chan stage boxes (digital snakes)
- Monitors & Systems
  - 3x EV PXM-12MP, 2x JBL EON610, 10" stage monitors.
  - 6x Behringer P16-M personal monitors via Ultranet. Allows each musician to adjust their own monitor mix. Analog output to wedge, Xvive or IEM.
  - 6x Xvive U4 wireless systems (plug in your own 1/8" earbuds).
- Vocal Mics
  - Wireless: Shure ULXD, 8 channel with SM58 handhelds, "Britney" mics, bodypacks, etc.
  - Wired: 5x Shure SM58, 1x Shure Beta 58A, 2x Behringer XM8500, 2x Audio-Technica AT2035 LDC.
- Instrument Mics
  - 3x guitar amp mics, GLS ES-57.
  - 1x bass amp mic, AKG P2.
  - Audix DP7, 7-piece drum mic set.
    - 1x D6 for kick drum.
    - 1x i5 for snare (clip on mic).
    - 2x D2s for toms (clip on mic).
    - 1x D4 for floor tom (clip on mic).
    - 2x ADX51s for overheads.
  - DI Boxes for Keys and/or guitar amps as needed.
- Backline & Misc
  - Fender Rumble 200 bass amp.
  - Mic stands, ~20+.
  - All cables.
- Not provided
  - Guitar and bass amps.
  - Bring vocal mics if desired.
  - IEMs.

# Band Questionnaire

- Band & band leader name \_\_\_\_\_
- Email & cell \_\_\_\_\_
- Band website, facebook, Instagram, etc. \_\_\_\_\_
- Music genre (classic rock, etc.) \_\_\_\_\_
- Band Members

No	Band Member Name	Description Lead/Rhy G, Bass, Mandolin, Keys, Drums, etc.	Instruments <b>Electric:</b> Direct Out or Mic an Amp? <b>Acoustic/Horn:</b> Mic on stand or clip-on mic?	Vocal Mic?	IEM or Wedge ?
1					
2					
3					
4					
5					
6					
7					
8					

- If applicable:
  - Bluegrass style "gather-round" mic configuration? \_\_\_\_\_
  - Drums: description of kit: \_\_\_\_\_ Preferred drum mics: \_\_\_\_\_
- Any additional Band info you can provide. ***Please attach a stage plot if available.***

---



---



---